

"BASIC" STAKING KIT

This kit provides the basic components needed to stake a majority of our most popular sizes of eyelets, rivets and terminals. The unskilled operator can produce professional looking assemblies quickly and with minimal training.

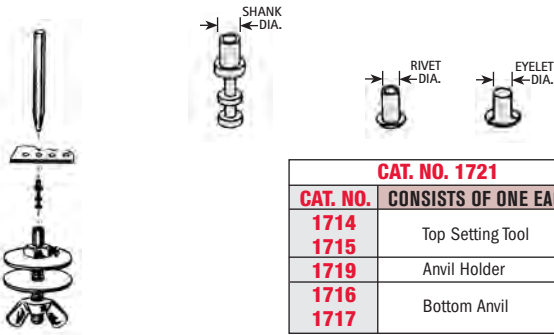

| CAT. NO. 1721 | |
|---------------|-----------------------|
| CAT. NO. | CONSISTS OF ONE EACH: |
| 1714 | Top Setting Tool |
| 1715 | Anvil Holder |
| 1716 | Bottom Anvil |

"MASTER" STAKING KIT

This kit provides all of the components needed to stake most terminals, standoffs, eyelets or rivets. This kit also includes sprung receding pins so that eyelets can be prealigned for easy assembly of components.

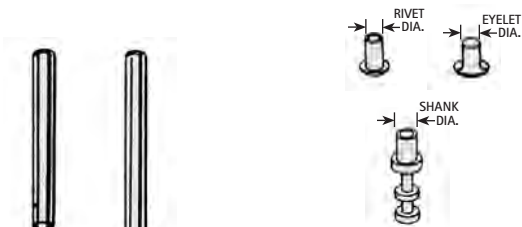

| CAT. NO. 1713 | |
|---------------|---------------------------------|
| CAT. NO. | CONSISTS OF ONE EACH: |
| 1714 | Top Swaging Tool |
| 1715 | |
| 1304 | |
| 1305 | |
| 1306 | |
| 1307 | |
| 1324 | Anvil for Turret Terminals |
| 1719 | |
| 1325 | Anvil for 6-32 Standoffs |
| 1326 | Anvil for Fork Turret Terminals |
| 1716 | |
| 1717 | |
| 1722 | Anvil for Fork Turret Terminals |
| 1726 | |
| 1315 | Receding Pin - .045 (1.15) Dia. |
| 1316 | Receding Pin - .069 (1.75) Dia. |
| 1321 | Return Spring for Receding Pins |

INDIVIDUAL TOOLS

TOP SETTING TOOLS (Swager)

For Single End Terminals, Eyelets or Rivets

| CAT. NO. | FOR SHANK DIA. |
|----------|----------------------------|
| 1714 | .062 (1.57) to .098 (2.49) |
| 1715 | .110 (2.8) to .125 (3.2) |

For Double End (Feed-Thru)

Hole in tool fits over Pin head and securely stakes the rivet part of terminal.

| CAT. NO. | FOR PIN ON RIVET END |
|----------|-----------------------|
| 1304 | .051 (1.30) Hole Dia. |
| 1305 | .063 (1.60) Hole Dia. |
| 1306 | .073 (1.85) Hole Dia. |
| 1307 | .086 (1.49) Hole Dia. |
| 1324 | .098 (2.49) Hole Dia. |

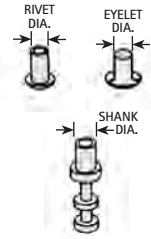
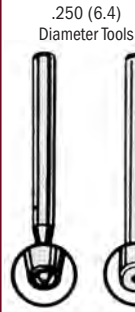

BOTTOM ANVILS

For Single End Terminals or Double End Terminals

Anvils have different size holes in each end therefore will accept 2 sizes of Pins of either Single or Double end Turret type Terminals.

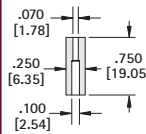

| CAT. NO. | HOLE ONE END | HOLE OTHER END |
|----------|--------------|----------------|
| 1722 | .053 (1.35) | .065 (1.65) |
| 1716 | .070 (1.78) | .100 (2.54) |
| 1717 | .128 (3.25) | .152 (3.86) |

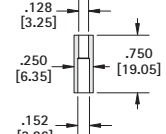

ANVILS FOR FORK TYPE TERMINALS

Accepts Diameter of 3/32 to 5/32 at one end and diameter of 3/16 other end .040 (1.0) slot one end and .060 (1.52) slot at other end.

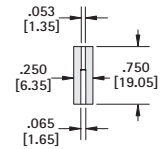

CAT. NO. 1726

ANVILS FOR STANDOFF BUSHINGS

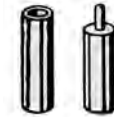

| CAT. NO. | BUSHING SIZE |
|----------|-------------------------------|
| 1326 | Holds Bushing with 5/32" O.D. |
| 1325 | For Bushing with 6-32 Thread |
| 1309 | For Bushing with 4-40 Thread |

TOOL HOLDERS



Tool holders will hold all .250 (6.4) diameter anvils. May be used with receding pin and return spring to hold eyelets in place during the staking process.

CAT. NO. 1719

"IMPACT" STAKING KIT

All that is required to stake almost all swage components. Just press down and it stakes. Tools provided allow bench top staking without setting up arbor or drill press. Staking tool can be adjusted to provide heavy to light blows. Receding sprung pins can be assembled into anvil to locate eyelets for easy assembly of components.



| CAT. NO. 1707 | |
|--|---------------------------------|
| CAT. NO. | CONSISTS OF ONE EACH: |
| TOOLS | |
| 1302 | Impact Handle |
| 1301 | Anvil Tool Holder |
| SWAGING TOOLS FOR SHANK DIAMETERS | |
| 1312 | .040 (1.02) to .072 (1.83) |
| 1313 | .078 (1.98) to .093 (2.36) |
| SWAGING TOOLS FOR DOUBLE ENDED TURRET | |
| 1310 | .053 (1.35) Diameter Hole |
| 1311 | .062 (1.57) Diameter Hole |
| ANVIL COMPONENTS | |
| 1716 | Anvil for Turret Terminals |
| 1717 | |
| 1722 | Anvil for Fork Turret Terminals |
| 1726 | |
| 1315 | Receding Pin - .045 (1.15) Dia. |
| 1316 | Receding Pin - .069 (1.75) Dia. |
| 1321 | Return Spring for Receding Pins |